

***BOSE***<sup>®</sup>



---

# Solo 15/10

## TV sound system

---

Owner's Guide | คู่มือผู้ใช้ | 사용자 안내서 | 用户指南 | 使用者指南 | دليل المالك

# Safety Information

---

## Please read this guide

Please read this owner's guide carefully and save it for future reference.



The lightning flash with arrowhead symbol within an equilateral triangle alerts the user to the presence of uninsulated, dangerous voltage within the system enclosure that may be of sufficient magnitude to constitute a risk of electric shock.



The exclamation point within an equilateral triangle, as marked on the system, is intended to alert the user to the presence of important operating and maintenance instructions in this owner's guide.



### WARNINGS:

- To reduce the risk of fire or electrical shock, do not expose the product to rain or moisture.
- Do not expose this apparatus to dripping or splashing, and do not place objects filled with liquids, such as vases, on or near the apparatus. As with any electronic products, use care not to spill liquids into any part of the system. Liquids can cause a failure and/or a fire hazard.



#### • Solo 10 remote:

**Warning:** Do not ingest battery, chemical burn hazard.

The remote control supplied with this product contains a coin/button cell battery. If the coin/button cell battery is swallowed it can cause severe internal burns in just two hours and can lead to death. Keep new and used batteries away from children. If the battery compartment does not close securely, stop using the product and keep it away from children. If you think the battery may have been swallowed or placed inside any part of the body, seek immediate medical attention. The coin/button cell battery may explode or cause a fire or chemical burn if incorrectly replaced or mishandled. Do not recharge, disassemble, heat above 212°F (100°C) or incinerate. Replace only with an agency approved (ex. UL) CR2032 or DL2032 3-volt lithium battery. Dispose of used batteries promptly.

- **Solo 15 remote:** Do not dismantle, open or shred battery pack or cells. Do not expose batteries or a battery pack to heat or fire. Avoid storage in direct sunlight. Do not short-circuit battery. Do not store batteries carelessly in a box or drawer where they may short-circuit each other or be short-circuited by other metal objects. Do not remove a battery from its original packaging until required for use. Do not subject batteries to mechanical shock. In the event of a battery leaking, do not allow the liquid to come in contact with the skin or eyes. If contact has been made, wash the affected area with copious amounts of water and seek medical advice. Observe the plus (+) and minus (-) marks on the battery and equipment and ensure correct use. Do not use any battery pack or cell which is not designed for use with the product. Keep batteries out of the reach of children. Seek medical advice immediately if a battery has been swallowed. Always purchase the correct battery for the equipment. Keep batteries clean and dry. Wipe the battery terminals with a clean dry cloth if they become dirty. Use the battery only in the application for which it was intended. When possible, remove the battery from the equipment when not in use. Replace only with AA (IEC LR06) alkaline batteries.
- Do not place any naked flame sources, such as lighted candles, on or near the apparatus.
- Never place the equipment in an unstable location. The equipment may fall, causing serious personal injury or death. Many injuries, particularly to children, can be avoided by taking simple precautions such as:
  - Using cabinets or stands recommended by the manufacturer of the equipment.
  - Only using furniture that can safely support the equipment.
  - Ensuring the equipment is not overhanging the edge of the supporting furniture.
  - Not placing the equipment on tall furniture (for example, cupboards or bookcases) without anchoring both the furniture and the equipment to a suitable support.
  - Not standing the equipment on cloth or other materials placed between the equipment and supporting furniture.
  - Educating children about the dangers of climbing on furniture to reach the equipment or its controls.
- If you doubt your ability to safely mount your television or set up this product, contact a professional installer for help.
- Do not allow children to push, pull, or climb on an A/V monitor. This may cause it to tip over, possibly resulting in personal injury or death. For added safety and stability, be sure to secure the monitor using a suitable anti-tip device.

# Safety Information



**WARNING:** This product contains magnetic material. Please contact your physician if you have any questions on whether this might affect the operation of your implantable medical device.



**WARNING:** Contains small parts which may be a choking hazard. Not suitable for children under age 3.



**CAUTION:** Do not make unauthorized alterations to the product; doing so may compromise safety, regulatory compliance, system performance, and may void the warranty.

## Notes:

- Where the mains plug or appliance coupler is used as the disconnect device, such disconnect device shall remain readily operable.
- This product must be used indoors. It is neither designed nor tested for use outdoors, in recreation vehicles, or on boats.
- The product label is located on the bottom or the back of the product.



廢電池請回收

**Please dispose of used batteries properly**, following any local regulations.

Do not incinerate.



This product conforms to all applicable EU Directive requirements. The complete Declaration of Conformity can be found at [www.Bose.com/compliance](http://www.Bose.com/compliance).

1. Read these instructions.
2. Keep these instructions.
3. Heed all warnings.
4. Follow all instructions.
5. Do not use this apparatus near water.
6. Clean only with a dry cloth.
7. Do not block any ventilation openings. Install in accordance with the manufacturer's instructions.
8. Do not install near any heat sources such as radiators, heat registers, stoves, or other apparatus (including amplifiers) that produce heat.
9. Protect the power cord from being walked on or pinched particularly at plugs, convenience receptacles, and the point where they exit from the apparatus.
10. Only use attachments/accessories specified by the manufacturer.
11. Unplug this apparatus during lightning storms or when unused for long periods of time.
12. Refer all servicing to qualified personnel. Servicing is required when the apparatus has been damaged in a way, such as power-supply cord or plug is damaged, liquid has been spilled or objects have fallen into the apparatus, the apparatus has been exposed to rain or moisture, does not operate normally, or has been dropped.



This symbol means the product must not be discarded as household waste, and should be delivered to an appropriate collection facility for recycling. Proper disposal and recycling helps protect natural resources, human health and the environment. For more information on disposal and recycling of this product, contact your local municipality, disposal service, or the shop where you bought this product.

# Safety Information

**NOTE:** This equipment has been tested and found to comply with the limits for a Class B digital device, pursuant to Part 15 of the FCC rules. These limits are designed to provide reasonable protection against harmful interference in a residential installation. This equipment generates, uses, and can radiate radio frequency energy and, if not installed and used in accordance with the instructions, may cause harmful interference to radio communications. However, there is no guarantee that interference will not occur in a particular installation. If this equipment does cause harmful interference to radio or television reception, which can be determined by turning the equipment off and on, you are encouraged to try to correct the interference by one or more of the following measures:

- Reorient or relocate the receiving antenna.
- Increase the separation between the equipment and receiver.
- Connect the equipment to an outlet on a different circuit than the one to which the receiver is connected.
- Consult the dealer or an experienced radio/TV technician for help.

Changes or modifications not expressly approved by Bose Corporation could void the user's authority to operate this equipment.

This device complies with part 15 of the FCC Rules. Operation is subject to the following two conditions: (1) This device may not cause harmful interference, and (2) this device must accept any interference received, including interference that may cause undesired operation.

This Class B digital apparatus complies with Canadian ICES-003.

CAN ICES-3 (B) / NMB-3 (B)

Names and Contents of Toxic or Hazardous Substances or Elements						
Part Name	Toxic or Hazardous Substances and Elements					
	Lead (Pb)	Mercury (Hg)	Cadmium (Cd)	Hexavalent (CR(VI))	Polybrominated Biphenyl (PBB)	Polybrominated diphenylether (PBDE)
PCBs	X	O	O	O	O	O
Metal parts	X	O	O	O	O	O
Plastic parts	O	O	O	O	O	O
Speakers	X	O	O	O	O	O
Cables	X	O	O	O	O	O
O: Indicates that this toxic or hazardous substance contained in all of the homogeneous materials for this part is below the limit requirement in SJ/T 11363-2006.						
X: Indicates that this toxic or hazardous substance contained in at least one of the homogeneous materials used for this part is above the limit requirement in SJ/T 11363-2006.						

## Please complete and retain for your records

The serial and model number can be found on the bottom panel.

Serial number: \_\_\_\_\_

Model number: \_\_\_\_\_

Purchase date: \_\_\_\_\_

We suggest you keep your receipt with this owner's guide.



**DOLBY**  
**DIGITAL**

Manufactured under license from Dolby Laboratories. Dolby and the double-D symbol are registered trademarks of Dolby Laboratories.

Blu-ray Disc™ is a trademark owned by Blu-ray Disc Association (BDA).

©2018 Bose Corporation. No part of this work may be reproduced, modified, distributed, or otherwise used without prior written permission.

## Introduction

Thank you.....	7
Unpacking.....	7

## System Setup

Step 1: Placing the system .....	8
Step 2: Choosing the type of audio cable to use.....	9
Step 3: Connecting the selected audio cable to your TV .....	10
Step 4: Connecting the audio cable to the Solo system .....	11
Important instructions for optical cable connections .....	12
Step 5: Connecting the Solo system to power .....	13
Step 6: Placing your TV on the Solo system.....	14
Step 7: Turning off your TV speakers .....	15
Step 8: Checking for sound.....	16
Step 9: Adjusting the bass.....	16
Using alternate connections.....	17
Connecting a cable/satellite box to the system .....	17
Connecting a TV headphones output to the system .....	18
Connecting multiple devices to the system.....	19

## Operation

Getting system information.....	20
Controlling the volume .....	21
Using auto-wake.....	21
Using the Solo 15 universal remote.....	22
Programming the Solo 15 universal remote .....	23
Locate the code .....	23
Enter the code .....	23
Test the code.....	23
Customizing the power button .....	24
Resyncing your cable/satellite box and TV .....	24
Switching between sources .....	24
Controlling the volume.....	25

# Contents

---

Function buttons .....	25
Using dialog mode .....	25
Using the Solo 10 remote .....	26
Optional Solo 15 system universal remote control .....	26
Using a non-Bose remote control .....	26
Using dialog mode .....	26
Troubleshooting .....	27

## Care and Maintenance

Replacing the remote batteries .....	29
Solo 15 universal remote .....	29
Solo 10 remote .....	29
Cleaning.....	30
Customer service.....	30
Limited warranty .....	30
Technical information.....	30

## Thank you...

Thank you for choosing the Bose® Solo 15/10 TV sound system for your home. This stylish, unobtrusive speaker system is designed to fit under most 46" TVs and many 50" TVs. It delivers superb acoustic performance that will greatly enhance your TV viewing experience.

## Unpacking

Carefully unpack the carton and confirm that you have all the parts shown here:

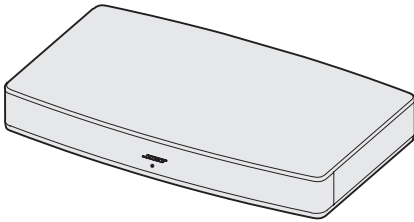

Solo 15/10 TV sound system



Solo 15  
universal remote

OR



Solo 10 remote

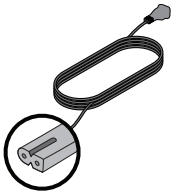

Power cord  
*(The appropriate power cord for your region is included)*



Optical digital  
audio cable

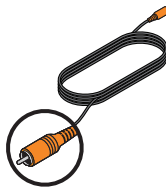

Coaxial digital  
audio cable  
*(Included in Europe only)*

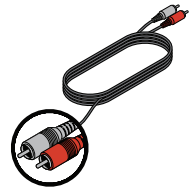

Analog stereo  
audio cable

If any part of the product appears to be damaged, do not attempt to use it. Contact your authorized Bose dealer immediately or call Bose Customer Service. Refer to the contact list enclosed in the carton for contact information.

Be sure to save the carton and packing materials. They provide the safest means for transporting or storing the product.

# System Setup

---

## Step 1: Placing the system

---

1. Move your TV aside and turn it so you can see the **Audio Out** panel.
2. Place the Solo system where you had your TV.

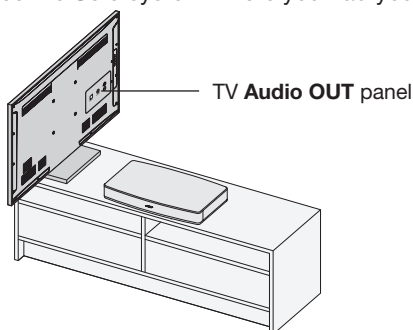

### Placement guidelines:

- The Bose® Solo 15/10 system is designed to fit under TVs that weigh no more than 75 lbs (34 kg) and have bases no wider than 24" (61 cm), and no deeper than 12.25" (31 cm).
- The base of your TV should be centered on the top of the system and must not hang over any of its edges.
- If the TV base is too large to fit on top of the system, place the sound system in another location such as on an open shelf under the TV, but keep it close to your TV so the audio cable will reach. You can also mount your TV on the wall above the system.
- If placing the sound system in a cabinet or on a shelf, position the front of the system as close as possible to the front edge of the shelf for optimum audio performance.

### Cautions:

- DO NOT place a CRT type TV on this system. It is not designed for use with this type of TV.
- Allowing the base of your TV to hang over any edge of this speaker system increases the risk of the TV tipping, which may result in injury.
- If placing the sound system backed up to a wall, make sure there is a space of at least 1" (2.5 cm) between the wall and the rear of the system.
- With any placement of this product, make sure the ventilation openings on the rear panel are not blocked.
- If your TV comes with an anti-tip device, install it according to the manufacturer's instructions and adjust the tether as instructed after placing the TV on top of the system. Installing an anti-tip device is recommended when using a TV with this product. If your TV did not come with an anti-tip device, you can get one from most retail TV suppliers.



## Step 2: Choosing the type of audio cable to use

1. On the back of your TV, locate the **Audio Out** connector panel and note which type of audio output connectors your TV has.

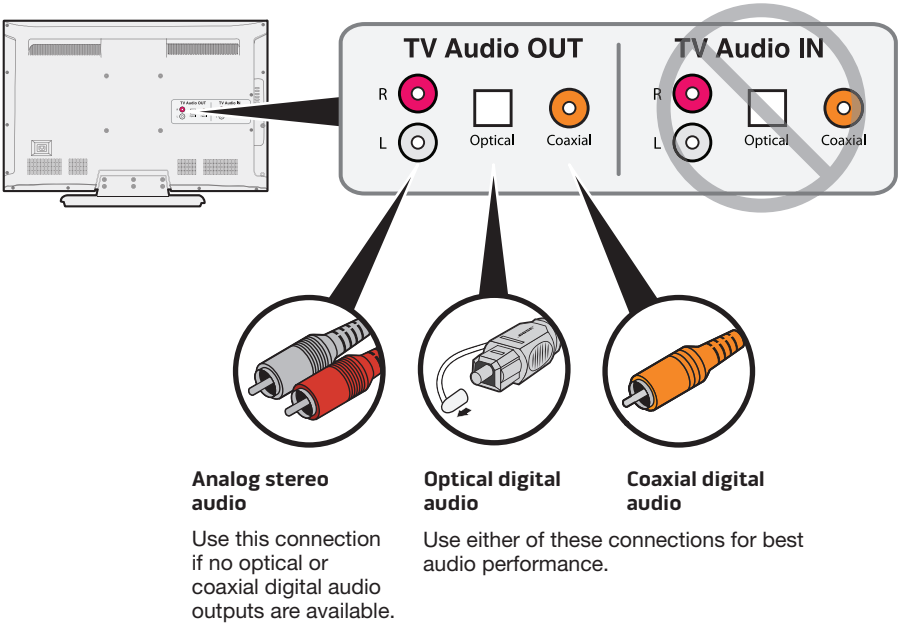

2. Choose the appropriate audio cable for your TV.

**Note:** Your Solo system may come with several types of audio cables. Only one audio connection is needed. Choose one cable and set the others aside.

**Note:** The optical or coaxial cable will provide the best audio performance. Use the analog cable only if your TV does not have an optical output or a coaxial output.

**Tip:** If your TV does not have any audio outputs, you can use the audio outputs on another device. See “Using alternate connections” on page 17 for other ways to connect the Solo TV sound system.

# System Setup

## Step 3: Connecting the selected audio cable to your TV

1. On the back of your TV, locate the **Audio OUT** connector panel.
2. Plug one end of the selected audio cable into the correct **Audio OUT** connector.

**Caution:** If using the optical cable, make sure you remove the protective cap and hold the plug in the correct orientation for the **Audio OUT** connector on your TV.

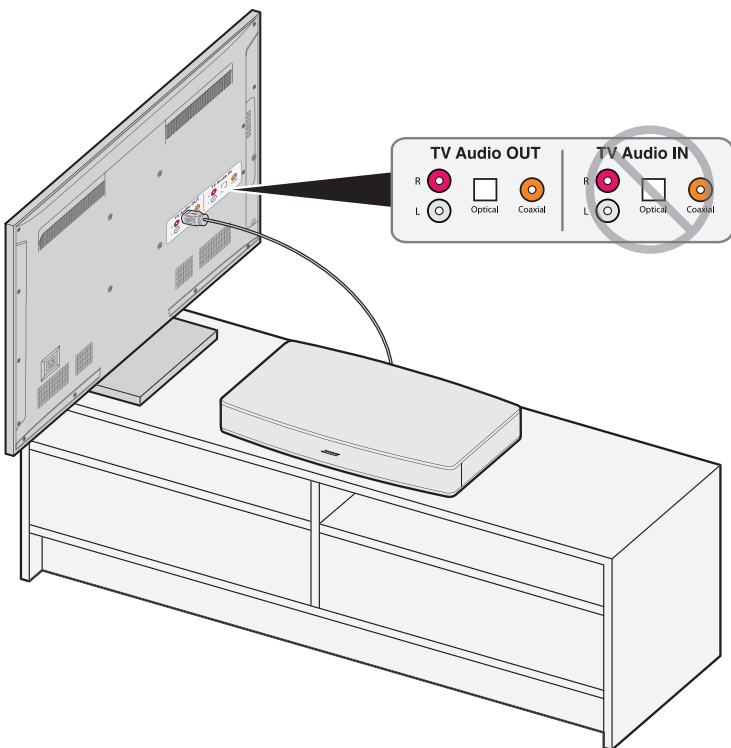

## Step 4: Connecting the audio cable to the Solo system

Plug the other end of the selected audio cable into the corresponding connector on the Solo system.

**Note:** If using the optical cable, please read the Important Instructions on page 12.

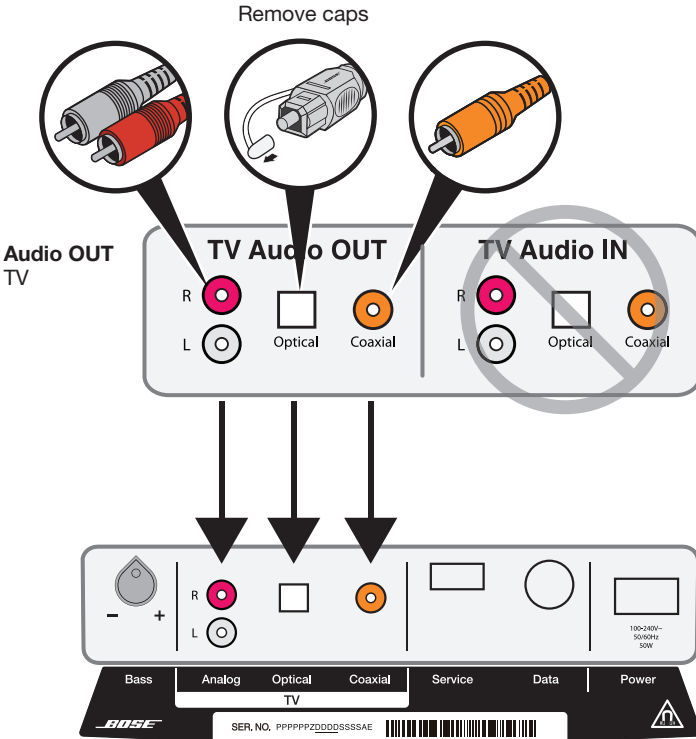

**Audio IN** Solo system

**Note:** Only one audio connection is needed.

# System Setup

## Important instructions for optical cable connections

1. Remove the protective cap from both ends of the optical cable.

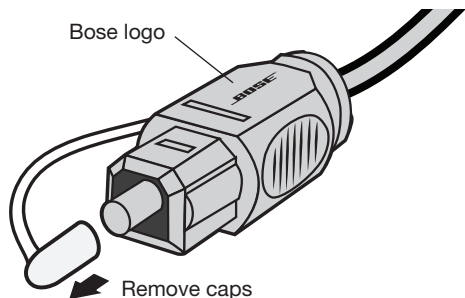

2. Hold the optical cable plug with the Bose logo facing up, as shown.
3. Align the plug with the **Optical** connector on the Solo system and insert the plug carefully.

**Note:** The **Optical** connector on the Solo system has a hinged door that swings out of the way when you insert the plug.

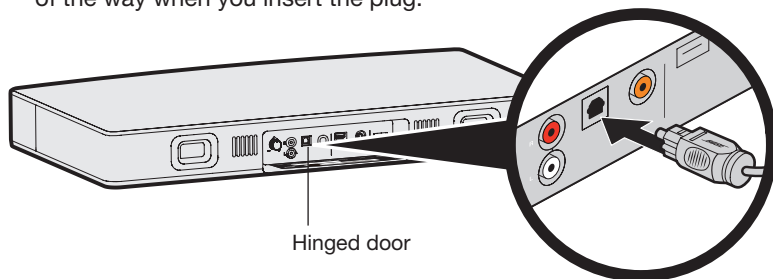

**Caution:** Inserting the plug in the wrong orientation can damage the plug and/or the connector.

4. **Firmly** push the plug into the connector until you hear or feel a click. Test to be sure the plug cannot easily slip out of the connector.

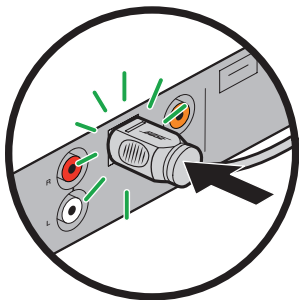



## System Setup

---

### Step 6: Placing your TV on the Solo system

---

Place your TV on the Solo system, making sure the TV stand is centered on the top of the system. Refer to "Placement guidelines:" on page 8.

**Caution:** Be sure to center the base of your TV on the top of this product.

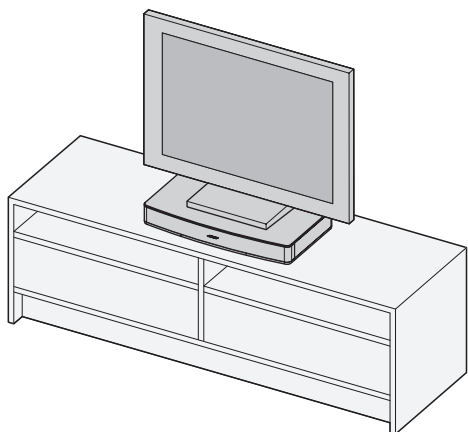

#### **Cautions:**

- DO NOT place a CRT type TV on this system. It is not designed for use with this type of TV.
- Allowing the base of your TV to hang over any edge of this speaker system increases the risk of the TV tipping, which may result in injury.
- If placing the sound system backed up to a wall, make sure there is a space of at least 1" (2.5 cm) between the wall and the rear of the system.
- If your TV comes with an anti-tip device, install it according to the manufacturer's instructions and adjust the tether as instructed after placing the TV on top of the system. Installing an anti-tip device is recommended when using a TV with this product. If your TV did not come with an anti-tip device, you can get one from most retail TV suppliers.

## Step 7: Turning off your TV speakers

To enjoy the full benefit of hearing TV audio through the Solo TV sound system, the internal speakers in your TV should be turned off.

**Note:** Check your TV owner's guide for help using the TV menus.

1. Turn on your TV.
2. Go to the TV menu and select **Audio**, **Sound**, or **Speaker Settings**.
3. Look for the menu item that allows you to turn off the TV speakers. This menu item may be called **Speakers On/Off** or something closely related.
4. If there is no setting for turning the TV speakers off, adjust the TV volume to its lowest setting.

**To confirm your TV speakers are turned off:**

1. Press  (mute) on the Solo remote.
2. Check that no sound is coming from your TV.

**Tip:** If you connected your TV to the Solo system using an optical digital cable, you may need to make sure that your TV's audio settings do not inhibit the audio output signal.

- Look for a menu item in your TV's Audio Settings that may affect digital audio output. You may have to select the digital output you want to use.
- Look for any setting that selects the type of audio output, such as **Stereo** or **5.1 Channel Audio** output. You may need to select such a setting in order to enable the audio output.

# System Setup

---

## Step 8: Checking for sound

---

1. Power on your TV and cable/satellite box (if needed).
2. Press  on the Solo system remote.

Make sure the system status indicator is solid green.

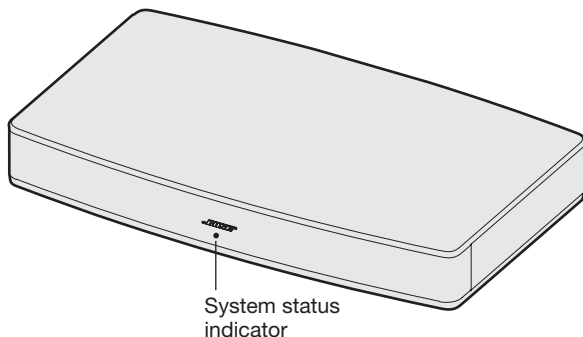

3. Check if sound is coming from the Solo system.  
If you do not hear sound from the Solo system see "Troubleshooting" on page 27.

**Tip:** At this time, you may consider setting your Solo system to automatically wake from standby whenever it receives a sound signal. See "Using auto-wake" on page 21.

## Step 9: Adjusting the bass

---

The bass control knob on the back of the system allows you to change the bass level output of the system.

Turn the bass control knob right to increase the bass, left to decrease the bass.

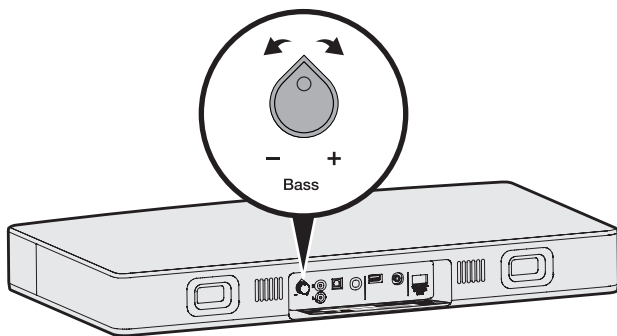

**Note:** For optimal sound quality for dialog-only programming, such as news and talk shows, see "Using dialog mode" on page 25 (Solo 15) or page 26 (Solo 10).



## Using alternate connections

You may need to use an alternate connection:

- If your TV does not have any audio output connections or does not deliver the audio to the Solo 15/10 system. See “Connecting a cable/satellite box to the system” or “Connecting a TV headphones output to the system” on pages 17-18.
- If you do not get sound from a DVD player that is connected to your TV. See “Connecting multiple devices to the system” on page 19.

### Connecting a cable/satellite box to the system

You can connect a cable/satellite box to the Solo 15/10 system. Only one cable is needed.

**Caution:** If using an optical cable, refer to page 12 for important instructions.

1. On the back of your cable/satellite box, locate the **Audio Out** connector panel and note which type of audio outputs your cable/satellite box has.

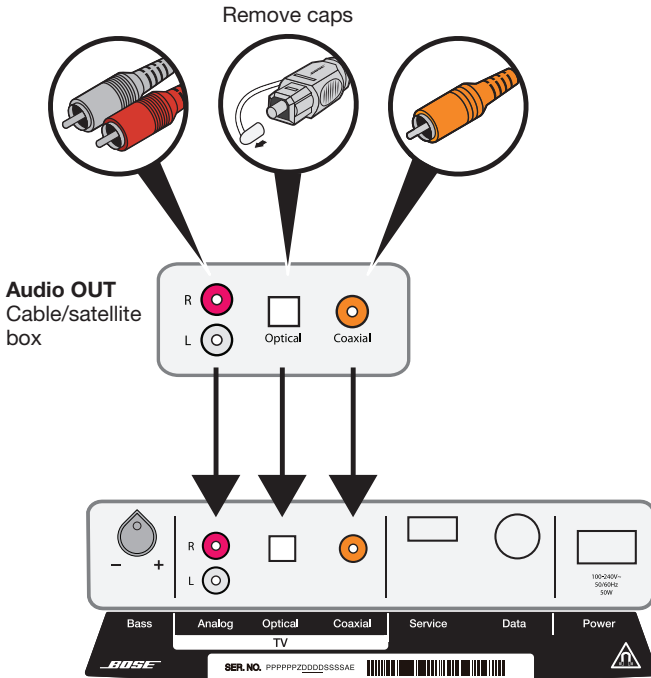

**Audio IN** Solo 15/10 system

2. Choose the appropriate audio cable for your cable/satellite box.
3. Connect the audio cable from your cable/satellite box's **Audio Out** connector panel to the Solo system.

# System Setup

## Connecting a TV headphones output to the system

If your TV only has a headphones connector, you need a dual RCA-to-3.5 mm stereo cable (not provided) to connect to the Solo 15/10 system.

1. Insert the stereo plug into the TV headphones connector.
2. Insert the white plug into the **L** connector on the Solo system.
3. Insert the red plug into the **R** connector on the Solo system.
4. Ensure your TV speakers are on. Refer to your TV's Owner's Guide for more information.
5. To ensure optimal volume control from your system, set your TV's volume to 75 percent of maximum; then set the volume level of your system using the remote control.

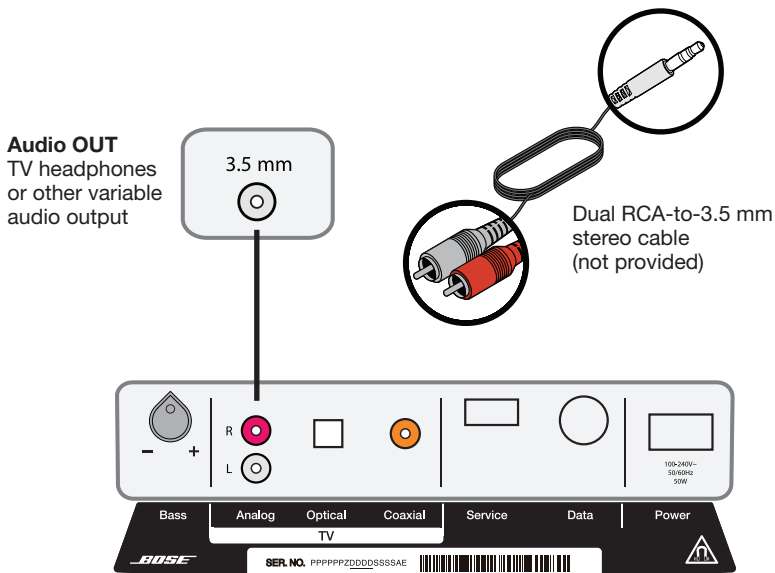

**Audio IN** Solo 15/10 system

## Connecting multiple devices to the system

If you have a device such as a DVD player connected to your TV, you may discover that your TV does not pass audio from the DVD player to the audio output on your TV. The Solo system provides a solution to this problem. You can connect up to three devices to the Solo system using a different type of audio cable for each.

For example, the figure below shows a cable/satellite box and a DVD player or game system connected to the Solo system.

**Note:** This alternate connection scheme may not work with the equipment you have in your home because some devices like cable/satellite boxes always remain on. When multiple devices are connected to the Solo system, turn on only the device you want to use and turn off the others.

**Caution:** If using an optical cable, refer to page 12 for important instructions.

**Audio OUT**  
DVD player or game system

**Audio OUT**  
Cable/satellite box

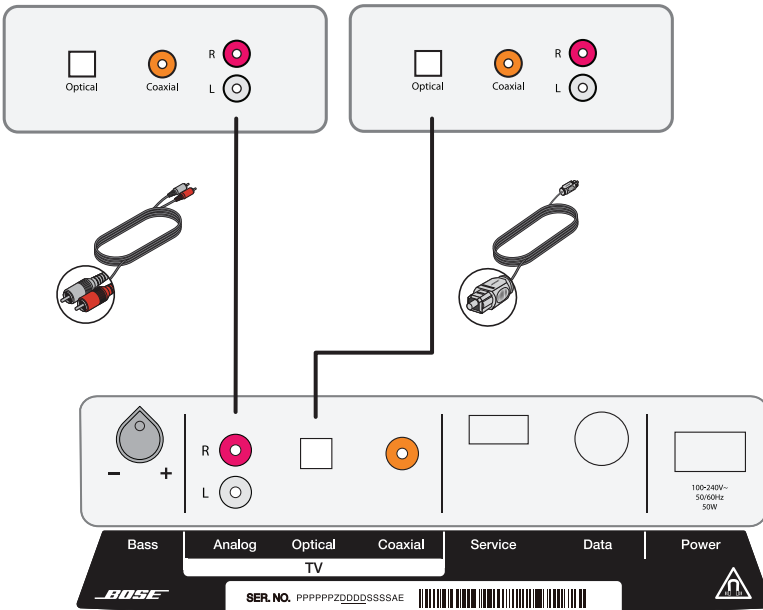

**Audio IN** Solo 15/10 system

# Operation

## Getting system information

The system status indicator tells you when the system is on and provides you with a system status during operation.

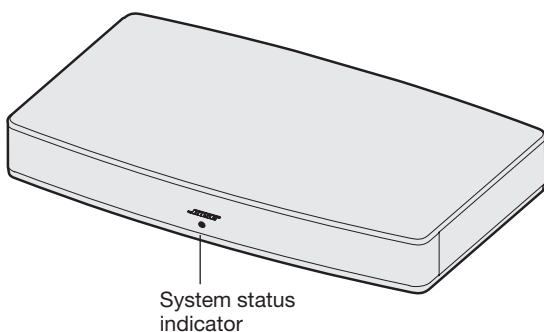

### System status:

Indicator activity	System state
Off	System off (standby)
Dim amber	Standby, auto wake is enabled
Solid green	Power is on
Blinking green or Blinking amber (if dialog mode is enabled)	System is muted
Fast blinking green or Fast blinking amber (if dialog mode is enabled)	Volume is being adjusted
Solid amber	Dialog mode is enabled
Solid red	System error - call Bose Customer Service

---

## Controlling the volume

---

On the remote:

- Press + to increase the volume.
- Press – to decrease the volume.
- Press  to mute or unmute the audio.

**Note:** To confirm your TV speakers are turned off, see page 15.

---

## Using auto-wake

---

When the Solo 15/10 system is powered on but not playing audio, the system powers off after one hour.

To wake the system, press  on the remote.

You can set the Solo 15/10 system to automatically wake whenever a sound signal is received.

### To enable auto-wake:

1. Point the remote at the system.
2. Press and hold  on the remote for 5 seconds.

The system emits three short *ascending* tones (going up) and the system status indicator flashes amber.

### To disable auto-wake:

1. Point the remote at the system.
2. Press and hold  on the remote for 5 seconds.

The system emits three short *descending* tones (going down) and the system status indicator flashes red.

**Note:** If your devices become out of sync, see “Resyncing your cable/satellite box and TV” on page 24.

# Operation

## Using the Solo 15 universal remote

Use the remote to control sources connected to your system, adjust the system volume, change channels, use playback functions, enable cable/satellite box functions and navigate the System menu.

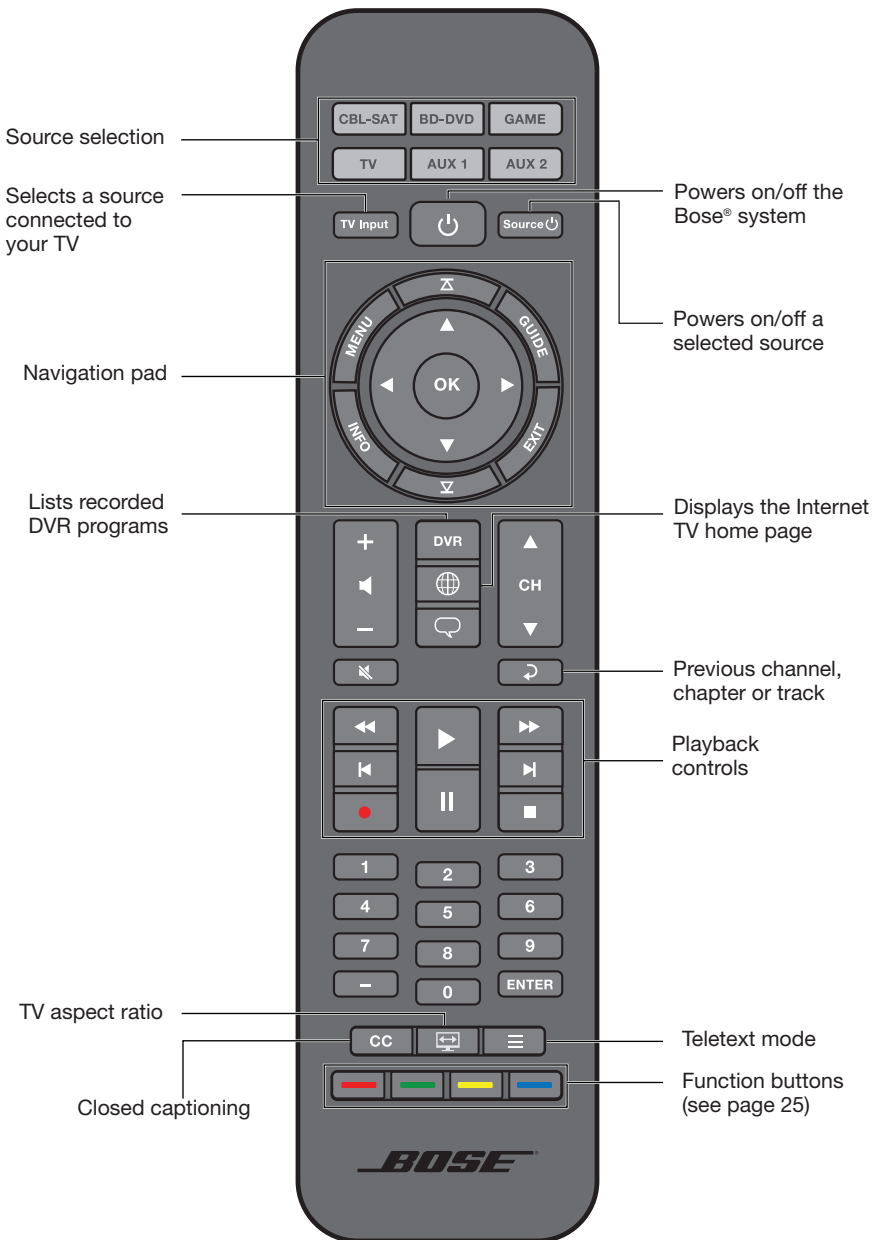

## Programming the Solo 15 universal remote

You can program the universal remote to control your TV, DVD, Blu-ray Disc™ player, cable/satellite box, game system or DVR.

### Locate the code

The remote works with several source brands.

1. Power on your source.
2. Locate the code for your source's brand in the *Universal Remote Device Codes* book (provided).

### Enter the code

Enter the four-digit code for your source's brand to begin programming the remote.

1. On the remote control, press and hold the appropriate source button until all six source buttons glow, then release.

For example, to program your TV, press and hold  .











The appropriate source button continues to glow.

2. On the number keypad, enter the code for your source's brand.

**Note:** If all six buttons blink three times, you entered an invalid code.  
Repeat steps 1 and 2.

### Test the code

After entering your code, test your source for basic functions. If your source does not respond, use the remote's code scanner to try a new code.

1. Press **+** on the volume button.
2. Test the source for basic functions:
  - **TV:** press the channel buttons. Press  . The settings menu appears. Press  and  to navigate.
  - **Cable/satellite box:** press  . The programming guide appears. Press  and  to navigate.
  - **DVD or Blu-ray Disc™ player:** press  . The settings menu appears. Press  and  to navigate.
  - **Game system:** press  and  to navigate through your menu.

**Note:** If your source does not respond to basic functions, repeat steps 1 and 2. If all six buttons blink three times, you have cycled through all codes for your source.

3. Press  to exit programming and save your settings.



**Note:** Your source may not be compatible with universal remote controls. Refer to your source owner's guide for more information.

# Operation

---



## Customizing the power button

You can customize the power button  on your remote to power on/off your Solo 15 system, TV and cable/satellite box simultaneously.

1. Program your remote to control your TV and cable/satellite box (refer to page 23).
2. Press  and  simultaneously and hold for ten seconds.  
Both buttons flash three times.

## Resyncing your cable/satellite box and TV





After customizing the power button, your cable/satellite box and TV may become out of sync and not power on/off simultaneously. Use the following steps to resync your system.

1. Press the source button for the device that is out of sync.
  2. Press  to power on/off the source.
  3. Press .
- Your devices power on/off simultaneously.

## Switching between sources

You can switch from one source to another by pressing the appropriate source button on the remote. In addition to controlling the selected source, the remote always controls the basic speaker functions (on/off, volume, mute) of your Solo 15 system.

**Note:** Before you begin, ensure you have correctly programmed your sources.

1. Press the button for the source you want to control.  
The source button glows.
2. Press .
3. Press  to select the correct input on your TV.  
You may need to press  several times to select the TV input for the source.  
On some TVs,  displays a menu. Use your Solo 15 system remote to choose the correct TV input and close this menu.



## Controlling the volume

On the remote:

- Press + to increase the volume.
- Press – to decrease the volume.
- Press  to mute or unmute the audio.

**Note:** To confirm your TV speakers are powered off, refer to page 15.

## Function buttons

The red, green, yellow and blue buttons on the remote control correspond with the color-coded function buttons on your cable/satellite box or teletext functions.

- Cable/satellite box functions: refer to your cable/satellite box owner's guide.
- Teletext functions: correspond with color-coded page numbers, headings or shortcuts on a teletext display.

## Using dialog mode

Dialog mode provides optimal sound quality for dialog-only programming, such as news and talk shows, by automatically adjusting the system's sound settings.

To enter dialog mode:

1. Point the remote at the system.
2. Press .  
The system status indicator blinks amber three times and then remains amber.

To exit dialog mode:

1. Point the remote at the system.
2. Press .  
The system status indicator blinks green three times and then remains green.

## Operation

### Using the Solo 10 remote

The Solo 10 TV sound system is easily operated using the small remote. Aim the remote at the front of the system and press the buttons.

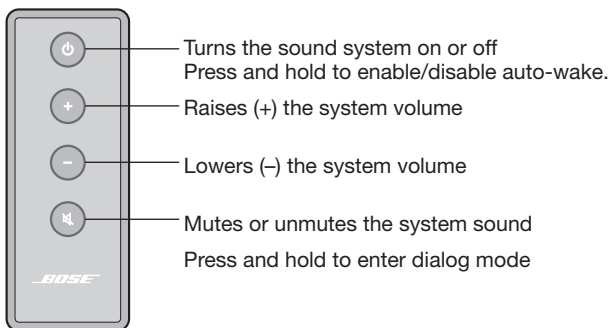

### Optional Solo 15 system universal remote control

Bose offers the Solo 15 system universal remote control for separate purchase. The remote will control the Solo 10 system and can be programmed to control your TV as well as other sources (such as a cable/satellite box). Contact Bose Corporation or your local dealer for more information. Refer to the contact sheet in the carton.

### Using a non-Bose remote control

You can program a non-Bose remote control, such as your cable/satellite box remote, to control the system. Refer to your non-Bose remote control owner's guide or cable/satellite website for instructions.

Once programmed, the non-Bose remote controls basic functions such as power on/off and volume.

### Using dialog mode

Dialog mode provides optimal sound quality for dialog-only programming, such as news and talk shows, by automatically adjusting the system's sound settings.

To enter dialog mode:

1. Point the remote at the system.
2. Press and hold .

The system status indicator blinks amber three times and then remains amber.

To exit dialog mode:

1. Point the remote at the system.
2. Press and hold .

The system status indicator blinks green three times and then remains green.

## Troubleshooting

Problem	What to do
TV base is too large to place on the system	<ul style="list-style-type: none"> <li>• Place the sound system in another location such as on an open shelf under the TV.</li> <li>• If possible, mount your TV on the wall above the sound system.</li> </ul>
No power	<ul style="list-style-type: none"> <li>• Make sure the power cord is securely connected on both ends.</li> <li>• Make sure the power cord is plugged into a live AC (mains) outlet. If the outlet is controlled by a switch, make sure the switch is in the ON position or test the outlet using a lamp.</li> <li>• Reset the system: Unplug the power cord for at least one minute. Plug the power in again and listen for the system to emit two tones confirming it has power.</li> </ul>
No sound	<ul style="list-style-type: none"> <li>• Make sure the Solo system is not muted.</li> <li>• Increase the volume.</li> <li>• Turn off all devices connected to the Solo system except the one you want to hear.</li> <li>• Make sure the audio cable is plugged into a connector on your TV labelled <b>Audio Output</b> or <b>Audio OUT</b>, not Audio Input or Audio IN.</li> <li>• Make sure all cable connections are correct and secure on the Solo system, TV, and other connected sources. If using an optical cable, refer to page 12 for important instructions.</li> <li>• Check that the correct TV input is selected.</li> <li>• Check that your TV's audio output is enabled. See your TV owner's guide for information.</li> <li>• If the sound system is connected to a TV output labelled VARIABLE (VAR), make sure the TV internal speakers are turned off, the TV volume is turned up, and the TV is not muted.</li> <li>• You may need to use an alternate connection. Refer to page 17.</li> <li>• If connecting through a TV headphones output, increase your TV volume to the maximum limit.</li> <li>• If connecting to two devices, ensure that you are not using an optical cable and coaxial cable.</li> <li>• Unplug the system's power cord from the AC (mains) outlet for one minute.</li> <li>• Reset the system: Unplug the power cord for at least one minute. Plug the power in again and listen for the system to emit two tones confirming it has power.</li> </ul>

# Operation

Problem	What to do
Remote control is inconsistent or does not work	<ul style="list-style-type: none"><li>• Check the batteries to see if they are installed properly or if they need to be replaced. See “Replacing the remote batteries” on page 29.</li><li>• Point the remote control at the sound system when you press a button.</li><li>• Check that the system status indicator on the sound system flashes when you press the remote volume or mute button.</li><li>• For the Solo 15 system remote<ul style="list-style-type: none"><li>- Point the remote control at the device you want to control.</li><li>- Check that the remote button for the selected source flashes when you press the volume button.</li></ul></li><li>• Unplug the system’s power cord from the AC (mains) outlet for one minute.</li><li>• Reset the system: Unplug the power cord for at least one minute. Plug the power in again and listen for the system to emit two tones confirming it has power.</li></ul>
Sound is distorted	<ul style="list-style-type: none"><li>• Make sure cable connections are secure on the sound system and TV.</li><li>• If the sound system is connected to a TV output labelled VARIABLE (VAR), reduce the TV volume.</li><li>• Bypass the TV and connect directly to the source using one of the Alternate setup methods. Refer to page 17.</li><li>• Reset the system: Unplug the power cord for at least one minute. Plug the power in again and listen for the system to emit two tones confirming it has power.</li></ul>
Sound is coming from the TV	<ul style="list-style-type: none"><li>• Turn off your TV’s internal speakers.</li><li>• Adjust the TV volume.</li></ul>
System status indicator is red	<ul style="list-style-type: none"><li>• System error. Call Bose Customer Service.</li></ul>

# Replacing the remote batteries

### Solo 15 universal remote

Replace both batteries when the remote control stops operating or its range seems reduced. Alkaline batteries are recommended.

1. Slide open the battery compartment cover on the back of the remote.
2. Remove both batteries.

Be sure to dispose of the batteries according to the regulations in your area.

3. Insert two AA (IEC-LR6) 1.5V batteries, or the equivalent. Match the + and – symbols on the batteries with the + and – markings inside the compartment.
4. Slide the battery compartment cover back into place.

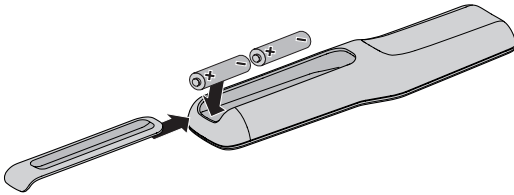

### Solo 10 remote

Replace the battery when the remote control stops operating or its range seems reduced.

1. Using a coin, turn the battery cover slightly counterclockwise.

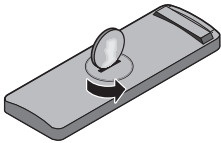

2. Remove the cover and insert the new battery (CR2032 or DL2032) flat side up, with the plus (+) symbol in view.

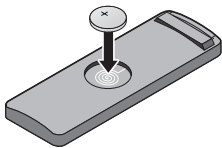

3. Re-seat the cover and turn it clockwise to lock into place.

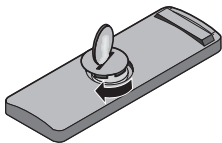

# Care and Maintenance

---

## Cleaning

---

- You can clean the surface of the speaker with a soft, dry cloth.
- Do not use any sprays near the speaker. Do not use any solvents, chemicals, or cleaning solutions containing alcohol, ammonia, or abrasives.
- Do not allow liquids to spill into any openings.
- The speaker grille requires no special care, although you may carefully vacuum it with a brush attachment, if necessary.

## Customer service

---

For additional help in solving problems, contact Bose Customer Service. Refer to the address sheet included with the Solo 15/10 TV sound system.

In the U.S. only, call: 800-901-0472.

## Limited warranty

---

Your Bose® Solo 15/10 TV sound system is covered by a limited warranty. Details of the limited warranty are provided on the product registration card that is included in the carton. Please refer to the card for instructions on how to register. Failure to register will not affect your limited warranty rights.

## Technical information

---

### Power rating

100-240V $\sim$  50/60 Hz 50W

### Dimensions

24.75" (62.8 cm) W x 14" (35.6 cm) D x 3" (7.6 cm) H

### Weight

12 lbs (6.35 kg)





717643-0020

***BOSE***<sup>®</sup>  
*Better sound through research*<sup>®</sup>

©2018 Bose Corporation, The Mountain,  
Framingham, MA 01701-9168 USA  
AM717643-0020 修訂版 00